



Licensing System in Slovakia

Riga, 22.9.2016

Dušan Hanus, Róbert Jakubáč,

Sources of legislation

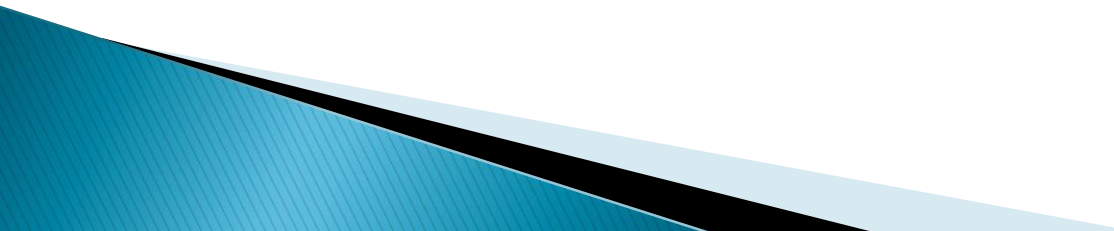
- ▶ Act no. 162/1995 Coll. on Real Estate Cadastre and on Registration of Ownership and Other Rights to Properties (Cadastral Act)
 - ▶ Act no. 215/1995 Coll. on Geodesy and Cartography
 - ▶ Act no. 216/1995 Coll. on Chamber of Surveyors and Cartographers
 - ▶ Act no. 455/1991 Coll. on Trade Licensing
- 

Geodetic and cartographic activities

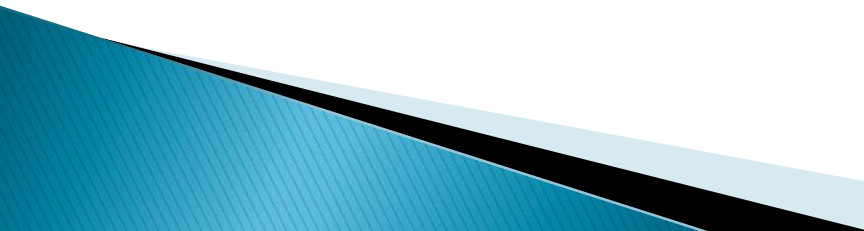
- ▶ geodetic and cartographic activities can be carried out by **an individual** who
 - has secondary or higher education in the field of geodesy and cartography
 - has a trade license or is in an employment relationship with a person who is authorized to carry out geodetic and cartographic activities
 - ▶ geodetic and cartographic activities can be carried out by a **legal entity** whose
 - responsible representative has secondary or higher education in the field of geodesy and cartography and has at least three years of experience in the field
 - ▶ license to carry out geodetic and cartographic activities is not conditioned to membership in the Chamber of Surveyors and Cartographers
- 

Selected geodetic and cartographic activities

- ▶ Act no. 215/1995 Coll. contains an exhaustive list of selected geodetic and cartographic activities

- ▶ selected geodetic and cartographic activities are, for example:

- ▶ survey sketches,
- ▶ surveying activities on land consolidation,
- ▶ plot boundary demarcation,
- ▶ establishment and updating of geodetic points,

Cadastral surveying

- ▶ establishment of control networks,
- ▶ setting out and control survey of building structures,
- ▶ surveying of displacements and deformations of building structures and technological facilities,
- ▶ surveying and displaying of as-built objects and setting out and inspection of geometrical parameters of industrial objects

Engineering surveying

- ▶ results of selected geodetic and cartographic activities must be **authoritatively verified**

- ▶ results of selected geodetic and cartographic activities must in some cases be also **officially verified**

Authoritative verification of results of selected geodetic and cartographic activities

- ▶ authoritative verification of the results of selected geodetic and cartographic activities is carried out by **an individual** who meets requirements set by law
- ▶ conditions for obtaining a license to authoritatively verify the results of selected geodetic and cartographic activities:
 - university degree in Geodesy and Cartography



- special professional qualification



- authorization granted by the Chamber of Surveyors and Cartographers

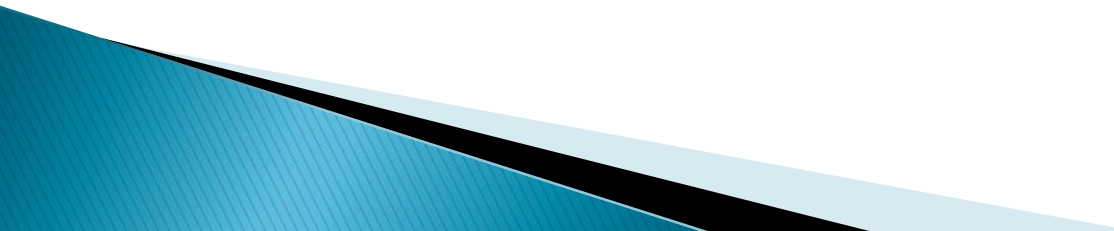

Special professional qualification for authoritative verification of the results of geodetic and cartographic activities

- ▶ for the purposes of **Engineering Surveying**:
 - ▶ a master's degree
 - ▶ 5 years of experience in carrying out the selected geodetic and cartographic activities for the purposes of engineering surveying after obtaining a master's degree
 - ▶ passing the qualification exam before a commission established by the **Chamber of Surveyors and Cartographers**
- 

Results of geodetic and cartographic activities in the field of Engineering Surveying

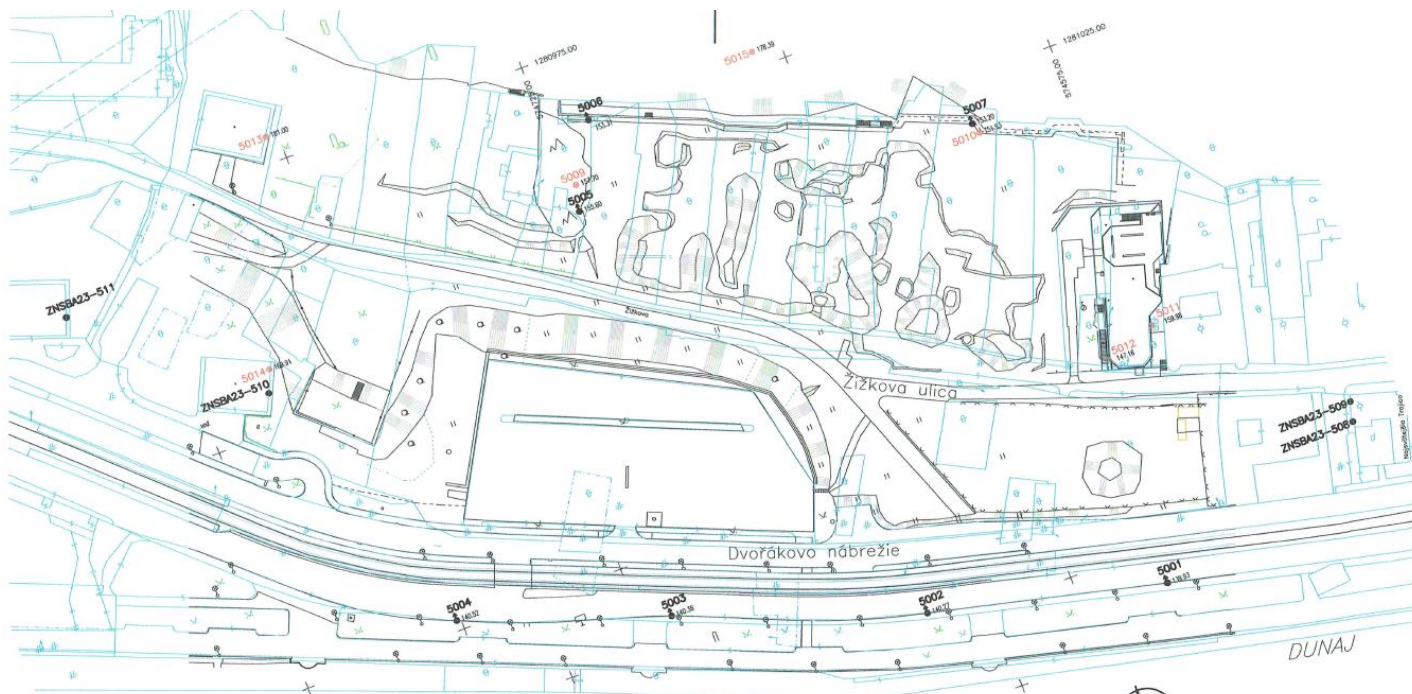

ZOZNAM SÓRADNÍC VYTYČOVACIEJ SIETE

č. bodu	Y	X	Z	prip. s
5001	574598.443	1281186.705	139.932	kl i nec. v obrub.
5002	574668.853	1281169.766	140.271	kl i nec. v obrub.
5003	574740.629	1281143.431	140.380	kl i nec. v obrub.
5004	574881.309	1281121.958	140.518	kl i nec. v obrub.
5005	574723.901	1281021.063	155.682	kl i nec. v skál. e
5006	574711.797	1280996.511	153.310	kl i nec. v bet. zákl.
5007	574664.884	1281038.294	153.199	kl i nec. v zobrazd. i
5009	574722.624	1281013.308	157.782	odrazka v skál. e
5010	574663.771	1281041.551	151.333	odrazka na bet.
5011	574575.795	1281113.321	159.978	odrazka na kov. rúre
5012	574591.571	1281118.253	147.162	odrazka na bet.
5013	574803.576	1280967.054	180.996	odrazka pri skale
5014	574827.110	1281032.098	169.911	odrazka v log. l.
5015	574658.788	1280994.929	178.393	odrazka v skál. e

Hlavné výškové body stavby 5001–5004 určené VPN
/ostatné trigonometricky/

LEGENDA

- meračské klince
- odrazné fólie
- vzťažné niv. body



Náležitosti a prenosnosť
vytvorené predpisom:



Polohové pripojenie: GPS – SKPOS
Výškové pripojenie : SNS

STN 01 3410, STN 01 3411

GEODET Ing. Boris Gabura Družicová 4 821 02, Bratislava tel.: 0903–431–085	Okres: Bratislava I.	Obec: BA m.č. Staré Mesto	Kat. územie: Staré Mesto
	Účel: Podklad pre vytyčovanie		
PREHLÁDNÝ NÁČRT BODOV ZVS ZÁKLADNÁ VYTYČOVACIA SIET' Č. 1			
Súradnicový systém: JTSK			
Výškový systém: Bpv	Zašiel: Ing. B. Gabura	Vyhotovil: Ing. B. Gabura	
Mierka: 1:1000	Dňa: 10.03.2014	Dňa: 17.03.2014	
Trieda presnosti: 3	Prevzal:		

Special professional qualification for authoritative verification of the results of geodetic and cartographic activities

- ▶ for the purposes of **Cadastral Surveying** :
- a master's degree
- 5 years of experience in carrying out the selected geodetic and cartographic activities for the purposes of cadastral surveying after obtaining a master's degree
- passing the qualification exam before a commission established by the **Geodesy, Cartography and Cadastre Authority of the Slovak Republic**

Authoritatively verified survey sketch

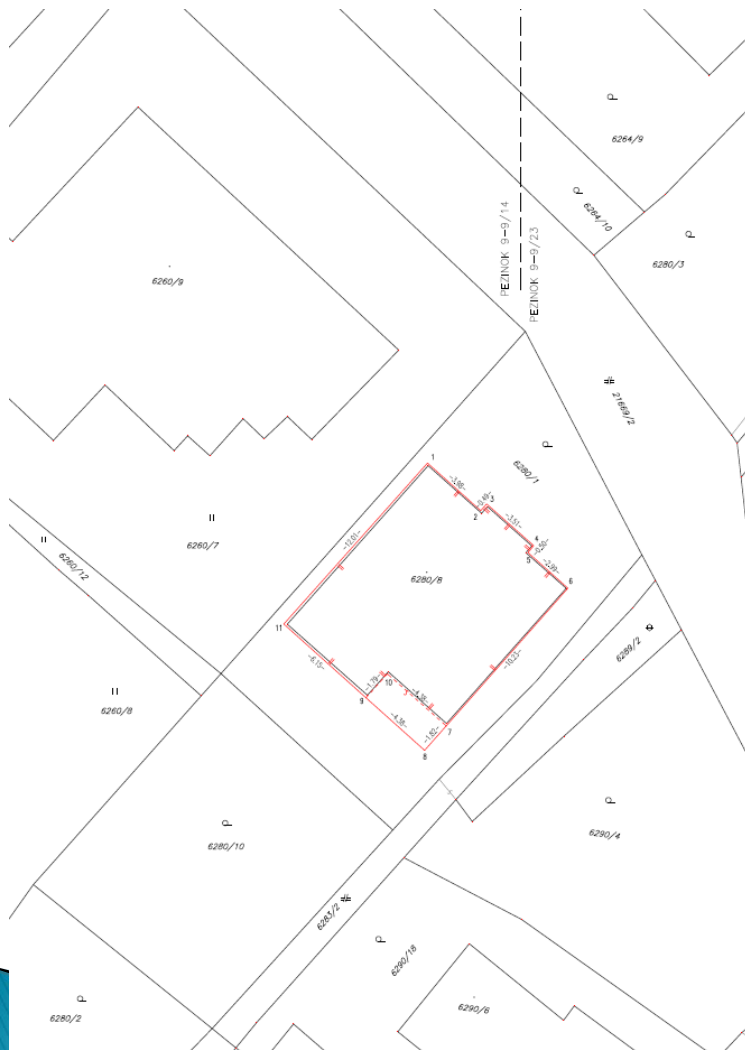

VÝKAZ VÝMER														
Doterajší stav					Zmeny				Nový stav					
Číslo		Výmera		Druh pozemku	Diel čísla	k parcele číslo	m ²	od parcely číslo	m ²	Číslo parcely	Výmera		Druh pozemku	Vlastník, (inš opráv. osoba) adresa, (sídlo)
PK vizážky	parcely	ha	m ²								ha	m ²		
LV	PK	KN	na	m ²							ha	m ²	kód	
7033		6280/1	192							6280/1	180		záhrada 4	Doterajší
7033		6280/8	116							6280/8	128		zast.pl. 15	PhDr. Katarína Leutichová Vúdlcová 1858/29 Bratislava
Spolu:			308								308		10	

Stav právny je totožný s registrom C KN

*Legenda: kód spôsobu využitia: 4 - Pozemok prevzatý v zariadenom území obce alebo v záhradárskej osade, na ktorom sa pestuje zelenina, ovocie, okrasná nžka a vysoká zeleň a iné poľnohospodárske plodiny
15 - Pozemok, na ktorom je postavená bytová budova označená registračným číslom*

kód druhu stavby: 10 - Rodinný dom

Geometrický plán je podkladom na právne úkony, keď údajy dosiaľšieho stavu výkazu výmer sú zhodné s údajmi platných výpisov z katastra nehnuteľnosti

Vyhotovitel Ing. Pavol Macko - Geodet Tokajčicka 20 82103 Bratislava mackop@stonline.sk iČo: 34719423		Kraj Bratislavský	Okres Bratislava III	Obec BA - m. č. Nové Mesto
		Kat. Územia Vinohrady	Číslo plánu 2107/2016	Mapový list č. Pezinok 9-9/14.23
GEOMETRICKÝ PLÁN				
Dňa: 22.7.2016		Meno: Ing. Pavol Macko		Uradné overenie Miesto: Bratislava Číslo: 5778
Nové hranice boli v prírode označené múrom		Nálezitosťami a prenesenou zodpovednosťou predpisom		Uradné overenie podľa § 9 zákona NR SR č. 215/1965 Z.z. o geodézii a kartografii
Záznam podrobného merania (meračský náčrt) č. 5778		Pediška a podpis		Pediška a podpis

Official verification of results of selected geodetic and cartographic activities

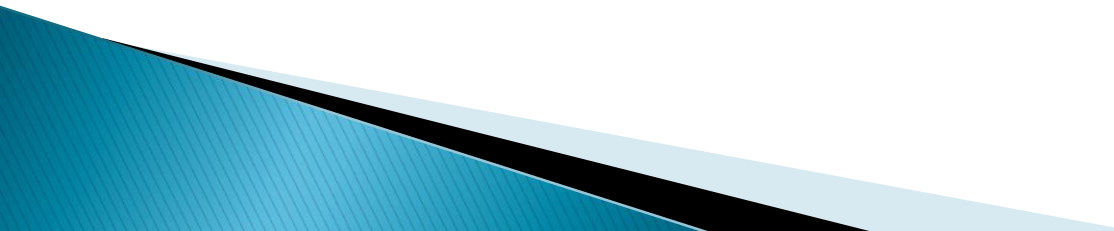
- ▶ official verification of the results of selected geodetic and cartographic activities for the purposes of cadastral surveying is carried out by an employee of a district office
 - ▶ the district office employee, who performs official verification of the results of selected geodetic and cartographic activities for the purposes of cadastral inspection, must comply with the conditions for entitlement to authoritatively verify the results of these activities.
 - ▶ official and authoritative verifications must not be performed by the same person
 - ▶ official verification is done due to adoption of results into the cadastral information system
- 

Authoritatively and officially verified survey sketch

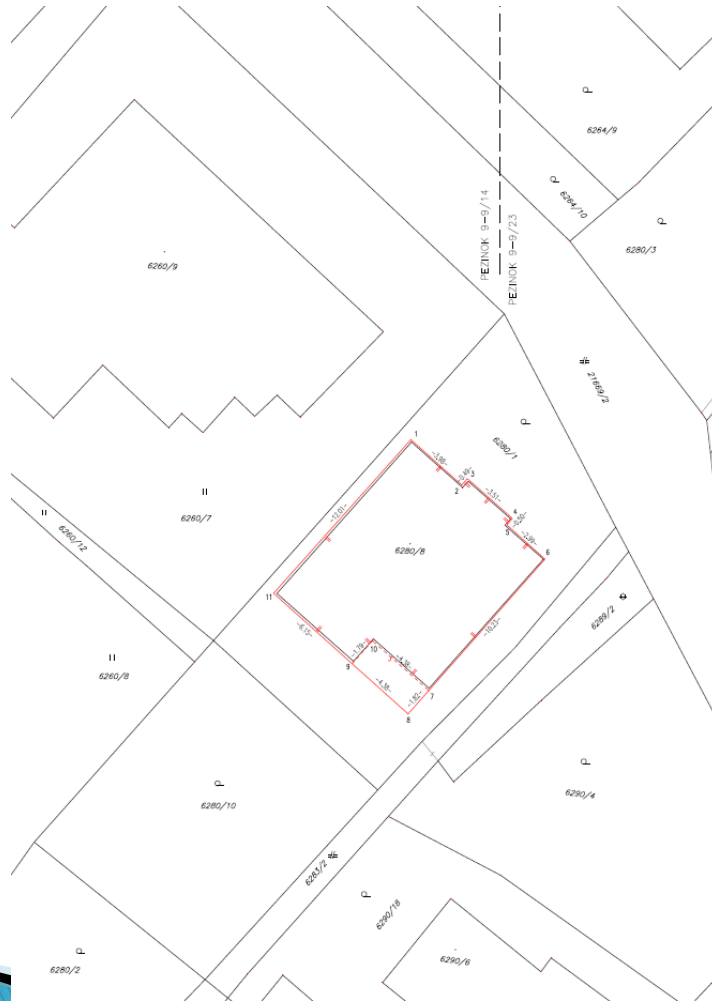

VÝKAZ VÝMER														
Doterajší stav				Zmeny				Nový stav						
PK vložky	Číslo parcely		Výmera	Druh pozemku	Diel číslo	k parcela číslo	m ²	od parcely číslo	m ²	Číslo parcely	Výmera		Druh pozemku	Vlastník (Iné opráv. osoba) adresa, (sídlo)
	LV	PK									KN	ha		
7033		6280/1	192	zdravica						6280/1	180		zdravica 4	Doterajší
7033		6280/8	116	zast.pl.						6280/8	128		zast.pl. 15	PhDr. Katarína Lettrichová Vrdlovská 1858/29 Bratislava
Spolu:			308								308			

Legenda: kód spôsobu využitia
 4 - Pozemok prevažne v zastavanom území alebo v zdravničárskej osade, na ktorom sa pestuje zelenina, ovocie, okrasné nízke a vysoké zeleň a iné poľnohospodárske plodiny
 15 - Pozemok, na ktorom je postavený bytový budova označený súpravným číslom



Kód druhu stavby: 10 - Rodinný dom

Spoplatnené v zmysle zákona č. 145/1995 Z.z.

Geometrický plán je podkladom na právne úkony, keď údajy doterajšieho stavu výkazu výmer sú zhodné s údajmi platných výpisov z katastra nehnuteľností

Vyhoviteľ Ing. Pavol Macko - Geodet Tokajčička 20 62103 Bratislava mackop@stonline.sk	Kraj Bratislavský	Oblasť Bratislava III	Obec BA - m. č. Nové Mesto
Kat. 62103 Bratislava	Číslo skúšky 2107/2016	Maťový list č. Pezinok 9-9/14, 23	
Uz. č. 34719423	GEOMETRICKÝ PLÁN zameranie stavby p.č. 6280/8 ku vydaniu kolaudačného rozhodnutia.		
Vyhoviteľ Meno: Ing. Pavol Macko	Autorizácia overiť Meno: Ing. Pavol Macko	Určenie overiť Meno: Ing. Martin Šimončík	
Dátum: 22.7.2016	Dátum: 22.7.2016	Dátum: 10.08.2016	Číslo: 1632/2016
Nové hranice boli v prítomnosti overené múrom			
Záznam podrobného merania (meračský náčrt) č. 5778			
Súhlasia bases, učených číslach a ostatné merania ústne sú určené vo všeobecnej dokumentácii			



Chamber of Surveyors and Cartographers

- ▶ the Chamber is an autonomous professional organization that brings together authorized surveyors and cartographers who authoritatively verify the results of selected geodetic and cartographic activities.
- ▶ the Chamber is a legal entity
- ▶ the seat of the Chamber is in Bratislava
- ▶ the Chamber organizes educational activities for its members
- ▶ <http://www.kgk.sk/>

Membership in the Chamber of Surveyors and Cartographers

- ▶ a member of the Chamber may be an individual who
- ▶ acquired a master's degree in academic field of Geodesy and Cartography and
- ▶ after gaining the master's degree has had at least five years of professional experience in selected geodetic and cartographic activities
- ▶ membership in the Chamber is mandatory for authorized surveyors and cartographers
- ▶ number of members in Cadastral Surveying - **351**
- ▶ number of members in Engineering Surveying - **189**
- ▶ number of members in Cadastral Surveying and Engineering Surveying - **196**

Geodesy, Cartography and Cadastre Authority of the Slovak Republic

- ▶ is the author of generally binding legal regulations and directives, guidelines and methodical instructions for carrying out the geodetic and cartographic activities
- ▶ establishes the Commission for verification of professional qualification for authoritative verification of the results of selected geodetic and cartographic activities in the field of cadastral surveying
- ▶ is an administrator of the **Information System of Geodesy, Cartography and Cadastre** of the Slovak Republic
- ▶ **Cadastral Inspection** of the Geodesy, Cartography and Cadastre Authority is the state supervision body for carrying out the geodetic and cartographic activities
- ▶ <http://www.skgeodesy.sk/sk/>



Thank you for attention

Riga, 22.9.2016

Dušan Hanus, Róbert Jakubáč,

dusan.hanus@skgeodesy.sk, robert.jakubac@skgeodesy.sk